



AN ISO 9001 : 2008 CERTIFIED CO.

## SYMBOL OF QUALITY

Pioneers In Solderless Terminals,  
Crimping Tools & Cable Glands



**BI-METALLIC CABLE LUGS & CONNECTORS** (Friction Welding)

**House of Designers & Makers of Terminals,  
Tools & Cable Glands Since 1961**

Catalogue 2016

## BI-METALLIC TERMINALS

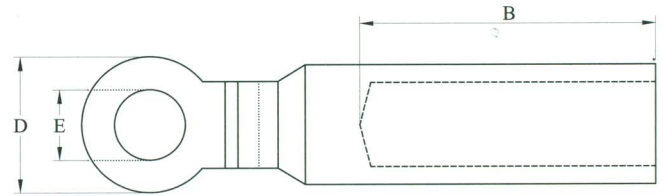
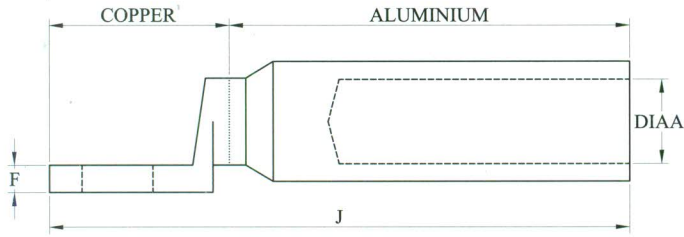

Sr. No.	Dowell's Cat. No.	Size (Sq-mm)	E	DIA A	B	F	D	J
1	CAF 25-10	25	10.5	7.5	30	4	19	70
2	CAF 35-10	35	10.5	8.5	30	4	19	70
3	CAF 50-13	50	13	10.2	35	5	24	85
4	CAF 70-13	70	13	11.5	45	5	24	90
5	CAF 95-13	95	13	13.5	50	5	24	95
6	CAF 120-13	120	13	15.5	55	6	30	105
7	CAF 150-13	150	13	16.5	60	6	30	110
8	CAF 185-13	185	13	18	60	7	35	130
9	CAF 240-13	240	13	22	65	7	35	135
10	CAF 300-17	300	17	23.5	70	7.5	36	140
11	CAF 400-17	400	17	26.5	75	7.5	36	145
12	CAF 500	500	-	30	95	10.5	50	200
13	CAF 630	630	-	34	95	10.5	60#	200

Note :-

\*All Dimensions are in mm

\*Raw Materials : (Copper : E. C. Grade as per IS-191)

(Aluminium : E. C. Grade as per IS - 5082)

\*Tolerances : +/- 5%

\*Joining Method : Friction Welding\*

\*# Square Palm of Given Dimension with as per Required E Hole

\*Recommended Crimping Tool SYE -150 B

# BI-METALLIC CONNECTORS



AN ISO 9001 : 2008 CERTIFIED CO.

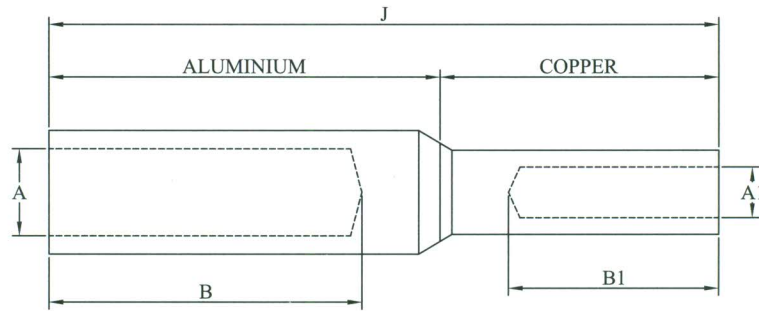

Sr. No.	Dowells Cat. No.	CABLE AREA (Sq-mm)		A	B	A1	B1	J
		Aluminium	Copper					
1	CACF-16-16	16	16	5.5	43	5.6	29	88
2	CACF-25-16	25	16	6.5	43	5.6	29	88
3	CACF-25-25	25	25	6.5	43	7	29	88
4	CACF-35-16	35	16	8	43	5.6	29	88
5	CACF-35-25	35	25	8	43	7	29	88
6	CACF-35-35	35	35	8	43	8	29	88
7	CACF-50-25	50	25	9	43	7	29	88
8	CACF-50-35	50	35	9	43	8	29	88
9	CACF-50-50	50	50	9	43	9.5	29	88
10	CACF-70-35	70	35	11	43	8	29	88
11	CACF-70-50	70	50	11	43	9.5	29	88
12	CACF-70-70	70	70	11	43	11	33	90
13	CACF-95-50	95	50	12.5	43	9.5	29	88
14	CACF-95-70	95	70	12.5	43	11	33	90
15	CACF-95-95	95	95	12.5	43	13	33	90
16	CACF-120-70	120	70	13.7	59	11	33	107
17	CACF-120-95	120	95	13.7	59	13	33	107
18	CACF-120-120	120	120	13.7	59	14.2	33	107
19	CACF-150-95	150	95	15.5	59	13	33	107
20	CACF-150-120	150	120	15.5	59	14.2	33	107
21	CACF-150-150	150	150	15.5	59	16	33	107
22	CACF-185-120	185	120	17	59	14.2	33	107
23	CACF-185-150	185	150	17	59	16	33	107
24	CACF-185-185	185	185	17	59	18	43	120
25	CACF-240-150	240	150	19.5	59	16	33	107
26	CACF-240-185	240	185	19.5	59	18	43	120
27	CACF-240-240	240	240	19.5	59	20	43	120

Note :-

\*All Dimensions are in mm

\*Raw Materials : (Copper : E. C. Grade as per IS-191)

(Aluminium : E. C. Grade as per IS - 5082)

\*Tolerances : +/- 5%

\*Joining Method : Friction Welding

\*# Square Palm of Given Dimension with as per Required E Hole

\*Recommended Crimping Tool SYE -150 B

WE RESERVE THE RIGHTS AT ANY TIME TO MAKE ANY SPECIFICATION OR DIMENSIONAL CHANGES DEEMED NECESSARY TO ENSURE ADVANCEMENT IN THE DESIGN OR MANUFACTURE OF ANY PRODUCT

# SALES NETWORK

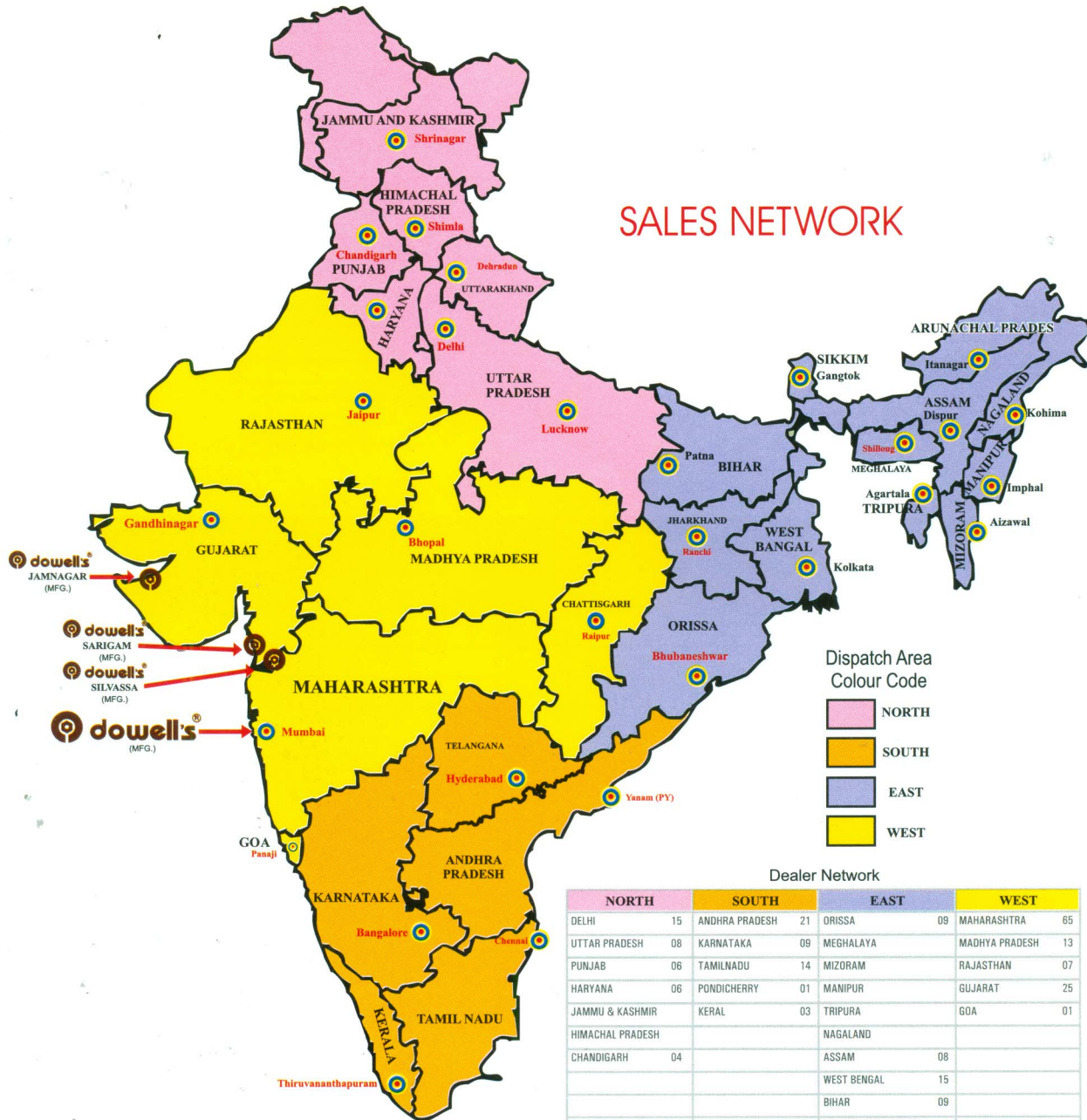

TOTAL NO. OF DEALERS - 239



AN ISO 9001 : 2008 CERTIFIED CO.

Corporate & Head Office :  
**DOWELL'S CABLE ACCESSORIES PVT. LTD.**

Gala No. 47/47A, Jagat Satguru Industrial Estate, Off Aarey Road, Goregaon (East), Mumbai - 400 063.

For Consumer Complaint Contact :

Officer Consumer Care Cell,

**DOWELL'S CABLE ACCESSORIES PVT. LTD.**

Gala No. 47/47A, Jagat Satguru Industrial Estate, Off Aarey Road, Goregaon (East), Mumbai - 400 063.

Tel. No. : 022 2927 0875 / 76 / 78 • Email : dowellsgroup@gmail.com • www.dowellselektro.com